

Preliminary - Not Final Design

UNDEVELOPED

RESIDENTIAL AREA

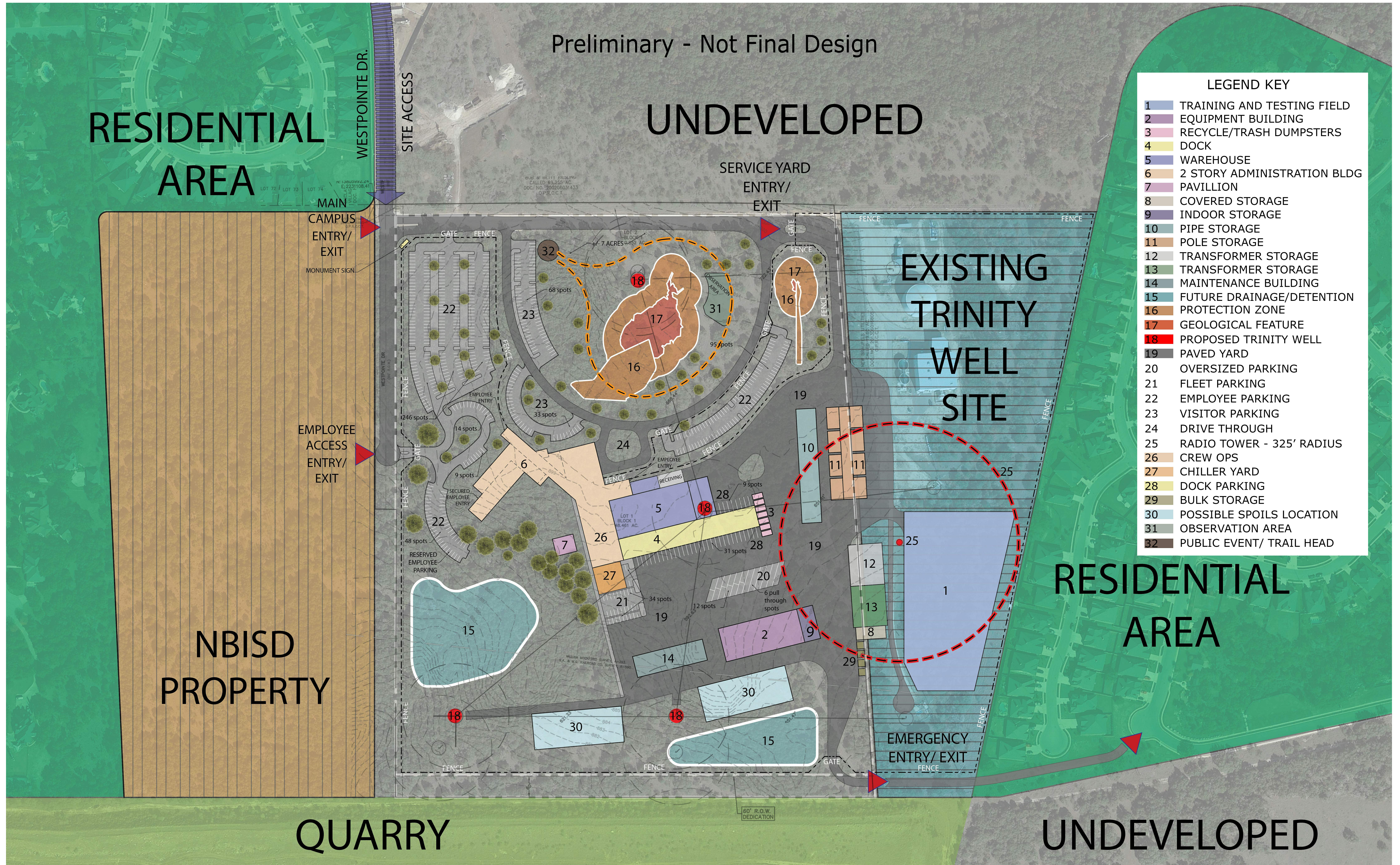

LEGEND KEY

- 1 TRAINING AND TESTING FIELD
- 2 EQUIPMENT BUILDING
- 3 RECYCLE/TRASH DUMPSTERS
- 4 DOCK
- 5 WAREHOUSE
- 6 2 STORY ADMINISTRATION BLDG
- 7 PAVILLION
- 8 COVERED STORAGE
- 9 INDOOR STORAGE
- 10 PIPE STORAGE
- 11 POLE STORAGE
- 12 TRANSFORMER STORAGE
- 13 TRANSFORMER STORAGE
- 14 MAINTENANCE BUILDING
- 15 FUTURE DRAINAGE/DETENTION
- 16 PROTECTION ZONE
- 17 GEOLOGICAL FEATURE
- 18 PROPOSED TRINITY WELL
- 19 PAVED YARD
- 20 OVERSIZED PARKING
- 21 FLEET PARKING
- 22 EMPLOYEE PARKING
- 23 VISITOR PARKING
- 24 DRIVE THROUGH
- 25 RADIO TOWER - 325' RADIUS
- 26 CREW OPS
- 27 CHILLER YARD
- 28 DOCK PARKING
- 29 BULK STORAGE
- 30 POSSIBLE SPOILS LOCATION
- 31 OBSERVATION AREA
- 32 PUBLIC EVENT/ TRAIL HEAD

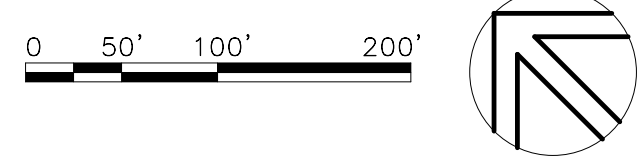

NBU Headquarters
FINAL OPTION

01/04/2021

NOT FOR REGULATORY APPROVAL,
PERMITTING OR CONSTRUCTION

ARCHITECT REGISTRATION NO. 13800

MarmonMok

ARCHITECTURE